

## 2/2 Way Piston Actuated Valve G 1/2" to 1" to Compact Version – Bronze

Specifications	
Type: CG NC flow over seat 1 → 2	
Type: RCG NO flow under seat 2 → 1	
Type: BCG NC Bi-directional flow over/under seat 1 → 2 / 2 → 1	
Type: DCG DA flow over/under seat 1 ↔ 2	
Media	Water, oil, air, steam <sup>1</sup>
Media Temperature	-10 to +180 °C
Ambient Temperature	-10 to +60 °C
Pilot Media <sup>2</sup>	Instrument air, inert gases
Actuator Body Material	Polyamide + 30% glass fiber
Body Material	Bronze (CB491K EN1982)
Bonnet Material	Brass (CW617N EN12165)
Seal Material	PTFE
Position Indicator	As standard

Options Available
NPT Connection (e.g. code CN205CTW00)
ATEX version (e.g. code CG205UTW00)

### Features and Benefits

- Waterhammer-free design for BCG - DCG (with flow direction 2 → 1)
- Actuator housing rotation 360°
- Design suitable for vacuum applications up to 10<sup>-2</sup> mbar
- ATEX version available

CE ATEX

II 2 G Ex h IIC T6 T4 T5 Gb

II 2 D Ex h IIC T85°C T100°C T135°C Db



Dimensions & Weights		DN15	DN20	DN25
Actuator	[mm]	Ø 45		
A	[mm]	65	75	90
B	[mm]	144	149	168
C	[mm]	136	142	161
D	[mm]	123	126	141
E	[mm]	57	57	57
Weight	[kg]	0.8	0.9	1.1

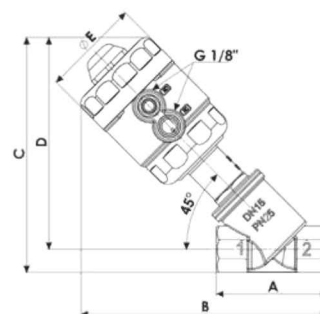

The products listed below comply with the requirements of the European Pressure Equipment Directive 2014/68/UE and carry the CE mark when required. The products fall within the following Pressure Equipment Directive categories:

Bodies	Group 1 gases	Group 1 liquids and Group 2 other fluids
DN15 to DN25 (PN25)	art. 4.3	art. 4.3

### ⚠ WARNING!

According to the European Pressure Equipment Directive 2014/68/UE liquids whose saturated vapour pressure at the maximum allowable temperature is more than 0,5 barg shall be considered as gases.

## 2/2 Way Piston Actuated Valve G 1/2" to 1" to Compact Version – Bronze

Valve	Body Connection	DN	Flow Rate Kvs	Working Pressure <sup>1</sup>		Flow Direction	Pilot Pressure <sup>3</sup>		Actuator Ø	Function
Code	[ISO 228G]	[mm]	[l/min]	[barg]	[barg]	—	[barg]	[barg]	[mm]	—
CG205CTW00	1/2"	15	75	0	16	1 → 2	3.8	10	45	NC
CG206CTX00	3/4"	20	133	0	16	1 → 2	5.8	10		
CG207CTY00	1"	25	208	0	16	1 → 2	6.5	10		
RCG205CTW00	1/2"	15	75	0	16	2 → 1	4	10	45	NO
RCG206CTX00	3/4"	20	133	0	16	2 → 1	6.2	10		
RCG207CTY00	1"	25	208	0	16	2 → 1	8.8	10		
BCG205CTW00	1/2"	15	75	0	16 / 16	1 → 2 / 2 → 1	6.2 / 5	10	45	NC bidirectional
BCG206CTX00	3/4"	20	133	0	16 / 7	1 → 2 / 2 → 1	8.7 / 5	10		
BCG207CTY00	1"	25	208	0	16 / 5	1 → 2 / 2 → 1	9.5 / 5	10		
DCG205CTW00	1/2"	15	75	0	16 / 16	1 ↔ 2	3	10	45	DA
DCG206CTX00	3/4"	20	133	0	16 / 16	1 ↔ 2	5	10		
DCG207CTY00	1"	25	208	0	16 / 16	1 ↔ 2	8.5	10		

### Notes

1. Steam max. working pressure 10 bar (9 barg)
2. Please contact M&M sales Department for other pilot media
3. Minimum pilot pressure at the max. working pressure: for lower working pressures please refer to the comparative charts
4. Pav ATEX performances are the same as weather proof pav